

Room Summary

Room Title: Mezz Level
 Room Temperature: 22.0°C
 Diurnal Ambient: 30.0°C
 Current Peak Time: 15.00 hrs
 Current Peak Month: July
 Maximum Peak Loads: 09.00 hrs in April

Customers Address: Bumper Lane
 Site Address: Chester

Total Room Loadings	Sensible Loads	Latent Loads	Total Cooling	Total Heating
Walls	3,307.0w	0.0w	3,307.0w	-6,149.0w
Windows	2,167.0w	0.0w	2,167.0w	-5,948.0w
Floor	2,421.0w	0.0w	2,421.0w	1,210.0w
Ceiling	25,546.0w	0.0w	25,546.0w	-26,543.0w
Infiltration	13,004.6w	20,483.6w	33,488.3w	-28,360.0w
People	3,520.0w	2,120.0w	5,640.0w	5,640.0w
Lighting	52,632.0w	0.0w	52,632.0w	52,632.0w
Appliances	0.0w	0.0w	0.0w	0.0w
Other Electrical	10,000.0w	0.0w	10,000.0w	10,000.0w
Total's	112,597.6w	22,603.6w	135,201.3w	2,482.0w

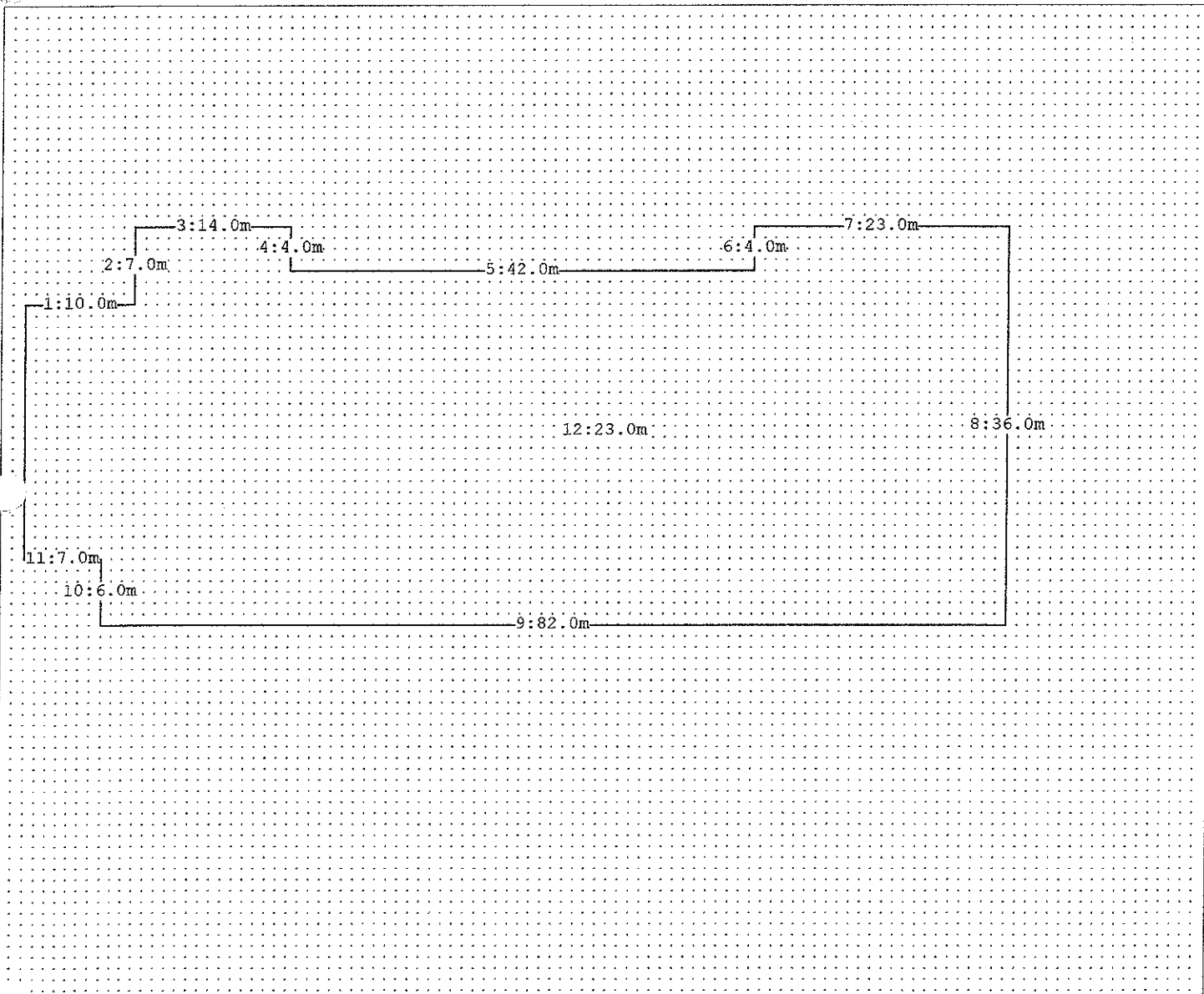

Cooling Load Graphs

Room Title: Mezz Level

Daily Loading

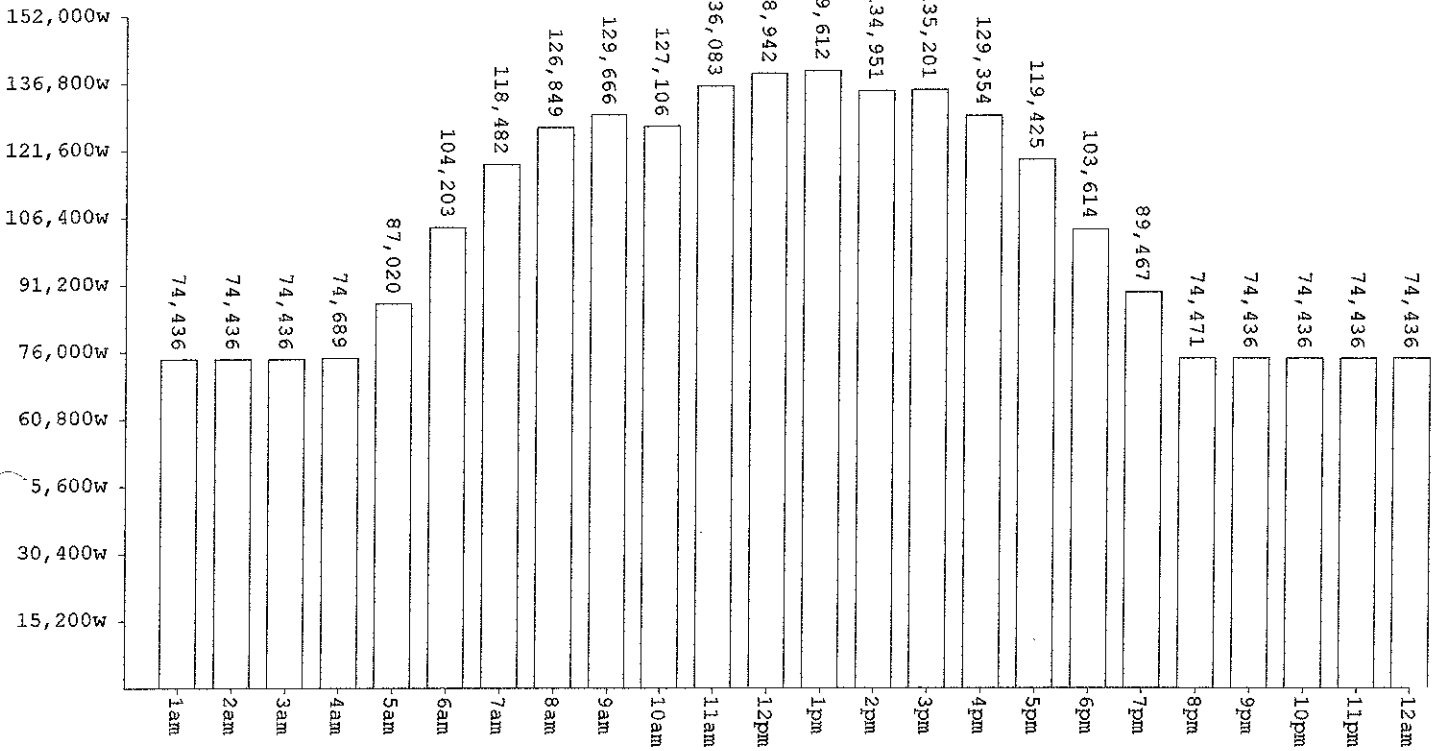

Monthly Loading

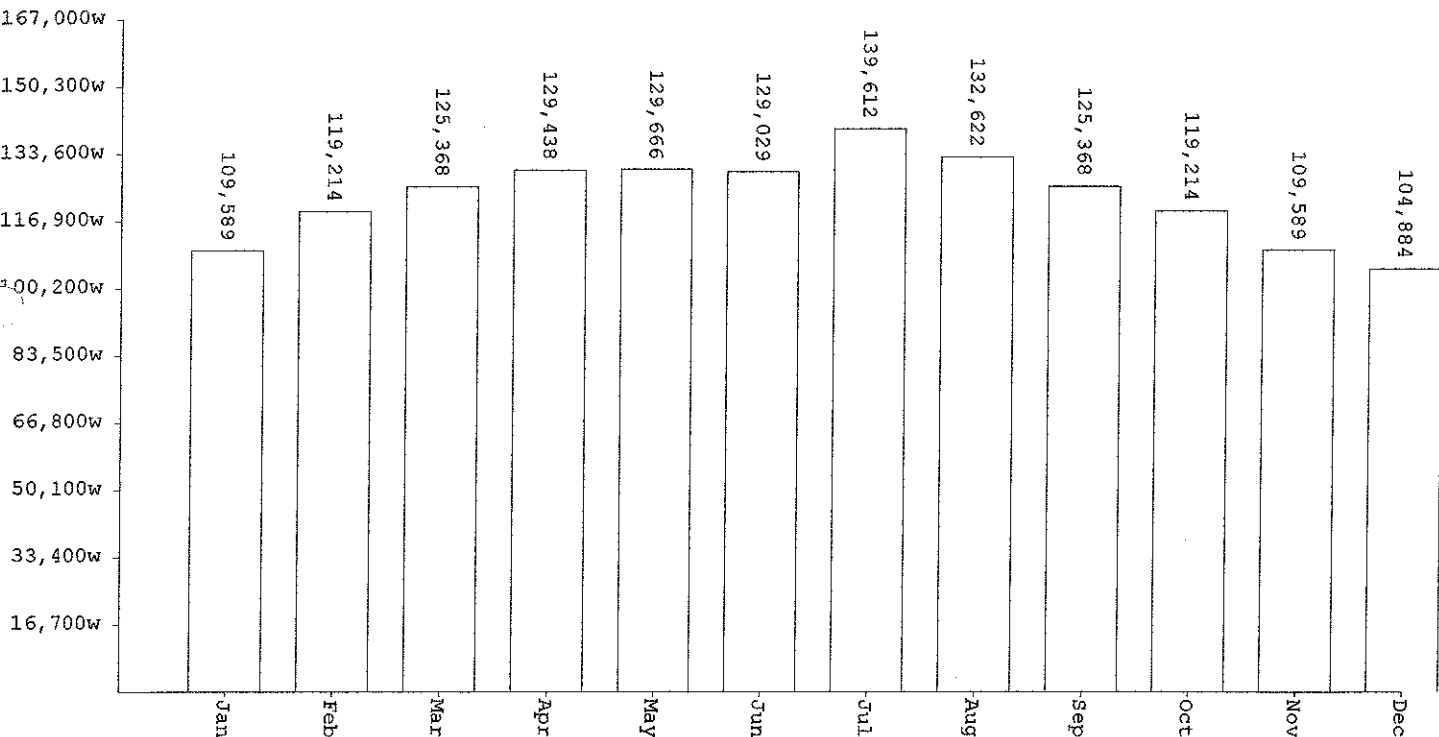

Room Details for Mezz Level (Zone: Zone 1)

Walls

Wall	Height	Length	Exp Area	R/Fact	A/Coef	S/Rad	'U'Factor	Thick	TD	Int/Ext	Orient	Gain	Solar	Total
1	3.0m	10.0m	36.8m ²	0.00	0.0	0w/m ²	0.45w/m ² K	250mm	3.0°C	Int	315.0°	50w	0w	50w
2	3.0m	7.0m	26.3m ²	0.00	0.0	0w/m ²	0.45w/m ² K	250mm	3.0°C	Int	225.0°	35w	0w	35w
3	3.0m	14.0m	50.8m ²	0.02	0.4	217w/m ²	0.45w/m ² K	250mm	8.0°C	Ext	315.0°	183w	88w	271w
4	3.0m	4.0m	15.8m ²	0.02	0.4	0w/m ²	0.45w/m ² K	250mm	8.0°C	Ext	45.0°	57w	0w	57w
5	3.0m	42.0m	148.8m ²	0.00	0.0	0w/m ²	0.45w/m ² K	250mm	3.0°C	Int	315.0°	201w	0w	201w
6	3.0m	4.0m	15.8m ²	0.00	0.0	0w/m ²	0.45w/m ² K	250mm	3.0°C	Int	225.0°	21w	0w	21w
7	3.0m	23.0m	82.3m ²	0.02	0.4	217w/m ²	0.45w/m ² K	250mm	8.0°C	Ext	315.0°	296w	143w	439w
8	3.0m	36.0m	127.8m ²	0.02	0.4	0w/m ²	0.45w/m ² K	250mm	8.0°C	Ext	45.0°	460w	0w	460w
9	3.0m	82.0m	288.8m ²	0.02	0.4	0w/m ²	0.45w/m ² K	250mm	8.0°C	Ext	135.0°	1,039w	0w	1,039w
10	3.0m	6.0m	22.8m ²	0.00	0.0	0w/m ²	0.45w/m ² K	250mm	3.0°C	Int	225.0°	31w	0w	31w
11	3.0m	7.0m	26.3m ²	0.00	0.0	0w/m ²	0.45w/m ² K	250mm	3.0°C	Int	135.0°	35w	0w	35w
12	3.0m	23.0m	82.3m ²	0.02	0.4	565w/m ²	0.45w/m ² K	250mm	8.0°C	Ext	225.0°	296w	372w	668w

Windows

Wall	Width	Height	Description	Trans	'U'Factor	Shading	Gain	Solar	Total
8	14.0m	2.9m	Optifloat Tinted 6mm 75/59 (Green) (Argon fill)	0.43	1.50w/m ² K	1.00	487w	0w	487w
9	50.0m	2.8m	Optifloat Tinted 6mm 75/59 (Green) (Argon fill)	0.43	1.50w/m ² K	1.00	1,680w	0w	1,680w

Floor

Exp Area	'U'Factor	Thick	TD	Total
2988.5m ²	0.45w/m ² K	250mm	2.0°C	2,421w

Ceiling

Exp Area	Int/Ext	Abs/C	S/Rad	'U'Factor	Thick	TD	Gain	Solar	Total
2988.5m ²	Ext	0.4	664w/m ²	0.45w/m ² K	250mm	8.0°C	9,671w	15,875w	25,546w

Infiltration

AC/hr	Amb Sat	O/Vent	OV Sat	OV Temp	Rm Sat	Rm Vol	Air Vol	Sensible	Latent	Total
0.5	50.0°C	1728.0m ³	50.0%	24.5°C	50.0%	8772.0m ³	6114.0m ³	13,005w	20,484w	33,488w

People

No.	Activity	Sensible	Latent	Total
40	Standing, Walking, Eating	3,520w	2,120w	5,640w

Appliances & Electrical

Qty	Description	Total
1	Lighting Load	52,632w
1	Other Electrical Loads	10,000w